

Friction fit the plug at the top of the fountain drilling.

An electric source is required; please check the cord length of your pump.

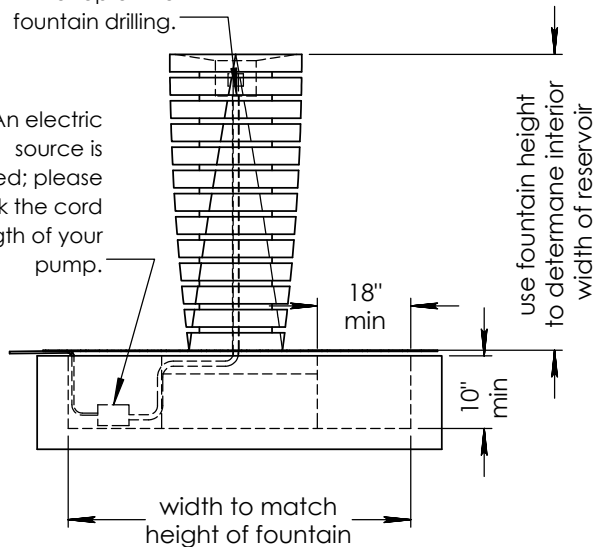

Cut a piece of grating that is larger than the hole for an access cover.

Create a hole in the grating for pump access.



Cut a hole in the screen to accommodate the hose

Use a galvanized metal grate to support the pebbles

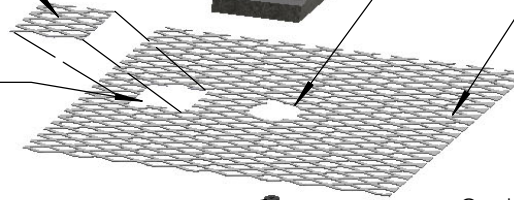

The plug should fit snugly into the top of the hole drilled through the fountain.

A flexible hose is supplied by StoneForest with the purchase of the fountain.

electric cord

Submersible Recirculating Pump. Auto-fill components are available from other suppliers.

Coat the interior with waterproofing material such as CIM or a similar product.

Size the pedestal according to the dimensions of the stone fountain base.

Block out a channel to allow for the hose. A PVC conduit can be installed. Ensure that the angle of the channel or conduit allows for the hose to feed freely without kinking.

The reservoir's interior must be at least 10" deep, with an 18" clear space around the fountain's edge to the reservoir's curb, ensuring it can contain any splashing.

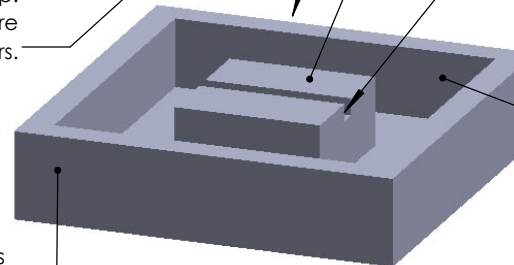

concrete can be formed to any shape, square is shown as an example



Custom Reservoir for Tiered Fountains

SIZE **A** DWG. NO. Custom Reservoir for Tiered Fountain

WEIGHT: SHEET 1 OF 1

©2022 Stone Forest, Inc.

Due to the hand-carving of each piece, small variances in shape and size are to be expected.

DO NOT SCALE DRAWING

NOTE:

- Install according to your local building codes.
- For the required wall thickness and concrete reinforcement to support the fountain weight, consult a concrete contractor or engineer.